

# HINO-338 (Cont.)

## FRONT SUSPENSION (Cont.)

Year	Model/Application	Part	P/C Qty	Figure
<b>King Bolt Set</b>				
2009-2008	10,000 lb. (FD961) Axle, 10.39" Length, 1.790" Pin Diameter, (Contains Composite Bushing, Two Keyways)	80063C	1	
2007-2005	10.39" Length, 1.790" Pin Diameter, (Contains Composite Bushing, Two Keyways)	80063C	1	
<b>STEERING</b>				
<b>Tie Rod End</b>				
2013-2005	5.440" Length, 1.125" - 12 Threads, (Greaseable Socket Reduces Corrosion/Wear)	Left ES423L ‡ Right ES423R ‡	1 1	

# HONDA TRUCK-CR-V

## FRONT SUSPENSION

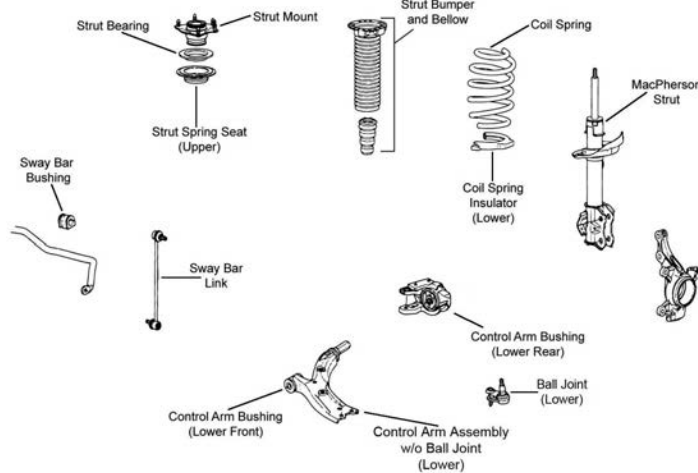

F425

Year	Model/Application	Part	P/C Qty	Figure
<b>Ball Joint</b>				
2016-2012	(Bolt On Type, Design Allows Ease Of Installation)	Lower	K500103 ‡	2 F425
2011-2010		Left Lower	K500307	1 F425
		Right Lower	K500306	1 F425
2009-2007	(Bolt On Type, Design Allows Ease Of Installation)	Lower	K500103 ‡	2 F425
<b>Control Arm Bushing</b>				
2011-2007	(Design Allows Ease Of Installation) (Design Allows Ease Of Installation)	Lower Rear	K200858 ‡	2 F425
		Lower Front	K200859 ‡	2 F425
<b>Control Arm with Ball Joint</b>				
2016-2015	(R-Series)	Left Lower	RK622943	1 F425
	(R-Series)	Right Lower	RK622942	1 F425
2014	(R-Series)	Left Lower	RK622931	1 F425
	(R-Series)	Right Lower	RK622930	1 F425
2011-2007	(R-Series)	Left Lower	RK620500	1 F425
	(R-Series)	Right Lower	RK620501	1 F425
<b>Strut Bumper Bellows</b>				
2016-2015	(Contains Bumper)		K90460	2 F425
2014-2007	(Contains Bumper)		K90461	2 F425
<b>Strut Mount</b>				
2014-2007	(Contains Bearing, Superior Rubber To Steel Bonding For Durability)		K160296 ‡	2 F425
<b>Sway Bar Bushing</b>				
2016-2007	(Contains Bushing And Brackets)	To Frame	K200519 ‡	1 F425
<b>Sway Bar Link</b>				
2016-2007	(Full Ball Stud Provides 360 Degrees Of Smooth Rotation)		K750297 ‡	2 F425

STEERING

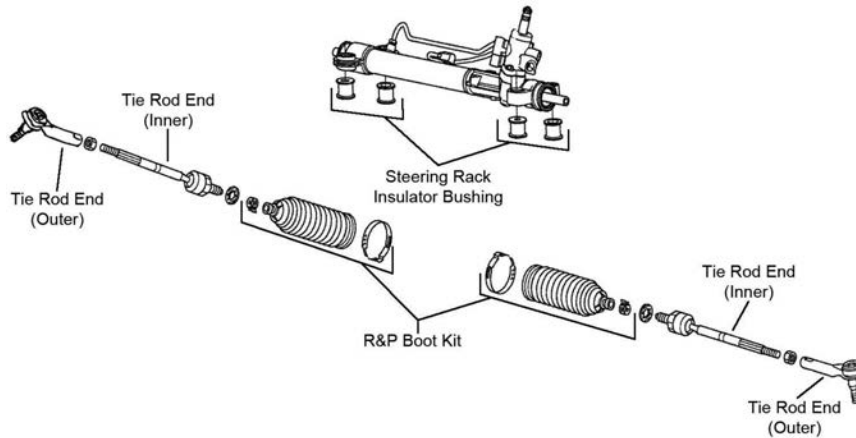

S132

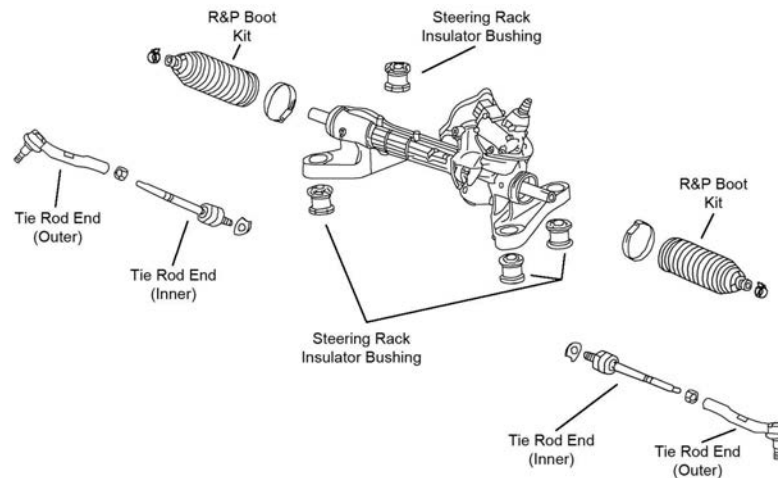

S200

Year	Model/Application	Part	P/C Qty	Figure	
<b>Rack &amp; Pinion Boot Kit</b>					
2011-2007	Japan Built - 1st Digit Of VIN J	K150282	2	S132	
<b>Tie Rod End</b>					
2016-2012	(Powdered Metal Gusher Brg. For Better Lubrication)	Left Outer	ES801157 ‡	1	S200
	(Powdered Metal Gusher Brg. For Better Lubrication)	Right Outer	ES801156 ‡	1	S200
	(Powdered Metal Gusher Brg. For Better Lubrication)	Inner	EV800937 ‡	2	S200
2011-2007	Japan Built - 1st Digit Of VIN J, (Powdered Metal Gusher Brg. For Better Lubrication)	Outer	ES800510 ‡	2	S132
	Japan Built - 1st Digit Of VIN J, (Design Allows Ease Of Installation)	Inner	EV800689 ‡	2	S132
	North American Built - 1st Digit Of VIN 1, 2, 3, 4 Or 5, (Powdered Metal Gusher Brg. For Better Lubrication)	Outer	ES800303 ‡	2	S132
	North American Built - 1st Digit Of VIN 1, 2, 3, 4 Or 5, (Design Allows Ease Of Installation)	Inner	EV800569 ‡	2	S132

# HONDA TRUCK-CR-V (Cont.)

## REAR SUSPENSION

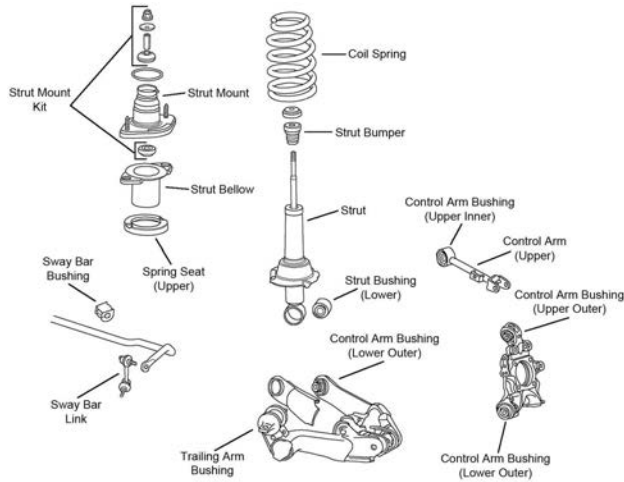

R105

Year	Model/Application	Part	P/C Qty	Figure	
<b>Control Arm</b>					
2016-2007	Minus 2 To Plus 4 Degrees Camber, (Adjustable, R-Series)	Upper	RK100046	2	R105
<b>Control Arm Bushing</b>					
2016-2007		Strut To Arm Lower	K80937	2	R105
<b>Strut Bumper Bellows</b>					
2016-2007	(Contains Bumper)		K90467	2	R105
<b>Strut Mounting Kit</b>					
2016-2007			K90646	2	R105
<b>Sway Bar Bushing</b>					
2014-2012		To Frame	K201299	1	R105
2011-2007	(Split Design For Easier Installation)	To Frame	K200205 ‡	1	R105
<b>Sway Bar Link</b>					
2016-2007	(Powdered Metal Gusher Brg. For Better Lubrication)	Left	K750156 ‡	1	R105
	(Powdered Metal Gusher Brg. For Better Lubrication)	Right	K750151 ‡	1	R105
<b>Wheel Hub &amp; Bearing Assembly</b>					
2016-2012	All Wheel Drive Front Wheel Drive		512501 512448	2 2	
2011-2007	All Wheel Drive Front Wheel Drive		512345 512344	2 2	

# HONDA TRUCK-Element

## FRONT SUSPENSION

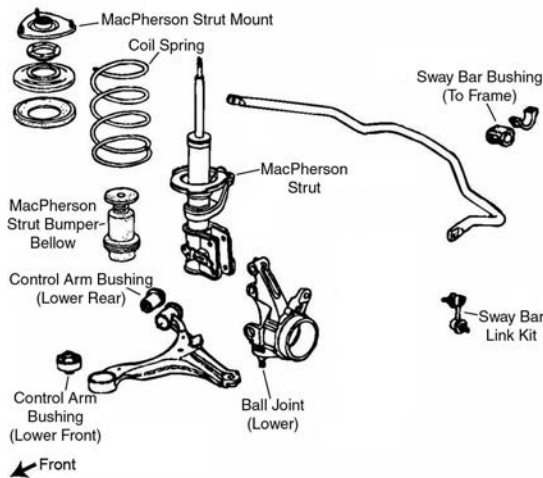

F038