

DODGE-Brougham (Cont.)

REAR SUSPENSION				
Year	Model/Application	Part	P/C Qty	Figure
Leaf Spring Shackle Bushing				
1977	(Split Type Bushing)	Upper Rear	K7308	2

DODGE-Challenger

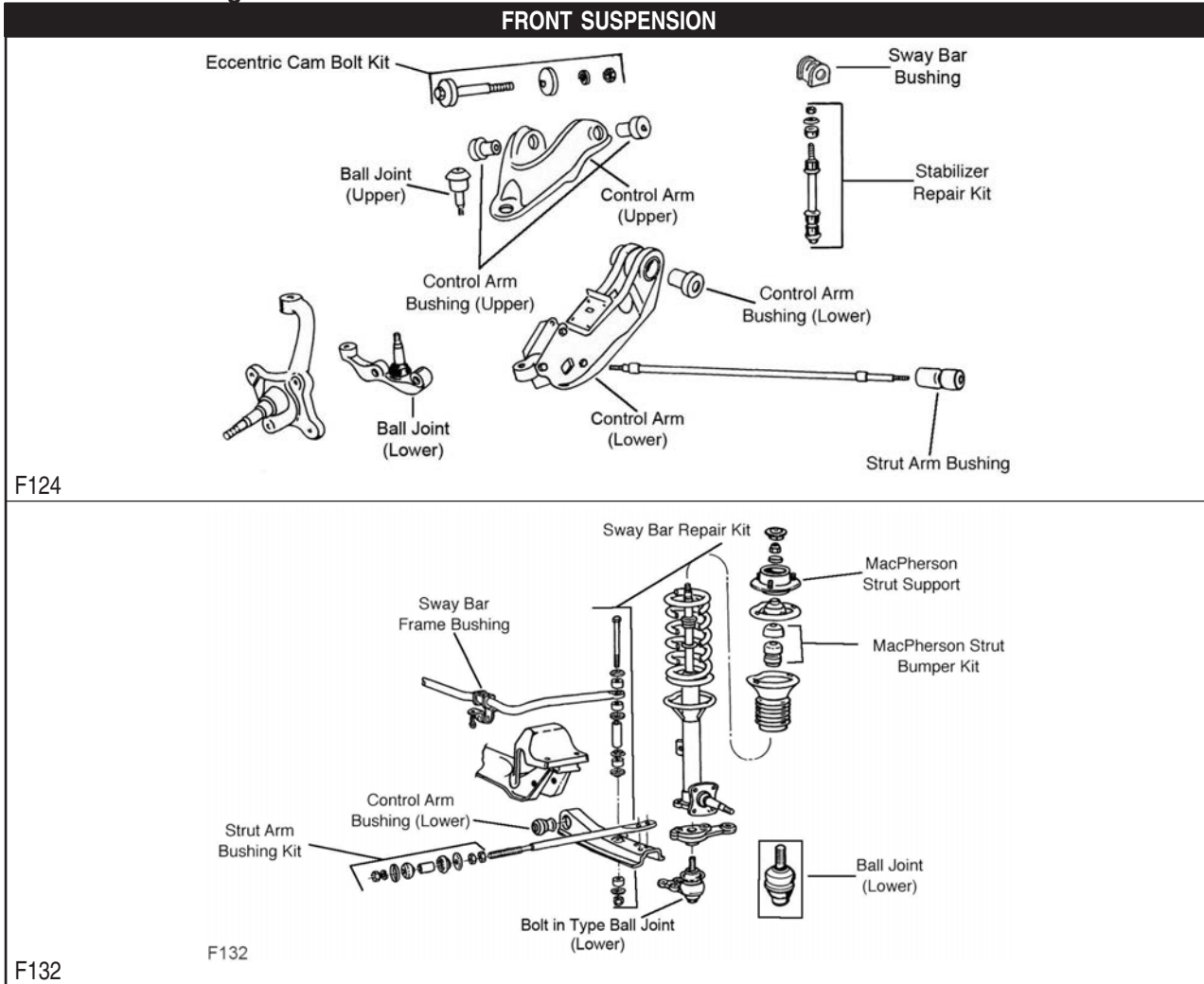

Year	Model/Application	Part	P/C Qty	Figure
Ball Joint				
1980-1978		Lower	K9077	2 F132
1974-1970	(Powdered Metal Gusher Brg. For Better Lubrication)	Upper	K772 ‡	2 F124
	(Powdered Metal Gusher Brg. For Better Lubrication)	Left Lower	K783 ‡	1 F124
	(Powdered Metal Gusher Brg. For Better Lubrication)	Right Lower	K781 ‡	1 F124
Control Arm Bushing				
1974-1970	(Optional, Eccentric Bushing, Provides Additional Positive(+) Camber Adjustment) (Standard Design, Contains Front And Rear Bushings)	Upper	K7103	2 F124
		Upper	K408	1 F124
		Lower	K791	2 F124
Strut Bumper Bellows				
1983-1978	(OE Material For Strut Performance And Longevity, Contains Bumper)		K90462 ‡	2 F132
Strut Mount				
1983-1981	(Contains Bearing)		K9390	2 F132
Strut Rod Bushing Kit				
1974-1970	(Improved Design) (Standard Design)		K7026	1
			K7016A	1
Sway Bar Bushing				
1974-1970	15/16" Sway Bar Diameter	To Frame	K5241	1 F124

FRONT SUSPENSION (Cont.)					
Year	Model/Application	Part	P/C Qty	Figure	
Sway Bar Repair Kit					
1983-1978	(Contains Thermoplastic Bushing) 5.5" Length, (Includes Polyurethane Bushings And Solid Metal Sleeve For Enhanced Performance. Barrel Nut Allows For Easier Installation.)	K90129 ‡ K700528 ‡	2 2	F132 F132	
1974-1970	5.5" Length, (Includes Polyurethane Bushings And Solid Metal Sleeve For Enhanced Performance. Barrel Nut Allows For Easier Installation.)	K700528 ‡	2	F124	
STEERING					
<p>S221</p>					
<p>S226</p>					
Year	Model/Application	Part	P/C Qty	Figure	
Idler Arm					
1974-1970	(Powdered Metal Gusher Brg. For Better Lubrication)	K7041 ‡	1	S221	
Idler Arm Repair Kit					
1983-1978	(For OE Design Idler Arm Only)	K9100	1	S226	
Pitman Arm					
1974-1973	Power Steering, (Greaseable Socket Reduces Corrosion/Wear)	K7076 ‡	1	S221	
Tie Rod Adjusting Sleeve					
1974-1970		ES319S	2	S221	
Tie Rod End					
1983-1978	(Includes Sunoloy-Coated Metal Bearing To Combine Durability With Smooth Stud Swing) (Includes Sunoloy-Coated Metal Bearing To Combine Durability With Smooth Stud Swing)	Outer ES2194R ‡ Left Inner ES2197R ‡	2 1	S226 S226	
1980-1978		Right Inner ES2198R	1	S226	
1974-1970	(Right Hand Threads, Powdered Metal Gusher Brg. For Better Lubrication) (Left Hand Threads, Powdered Metal Gusher Brg. For Better Lubrication)	Outer ES401R ‡ Inner ES401L ‡	2 2	S221 S221	

REAR SUSPENSION

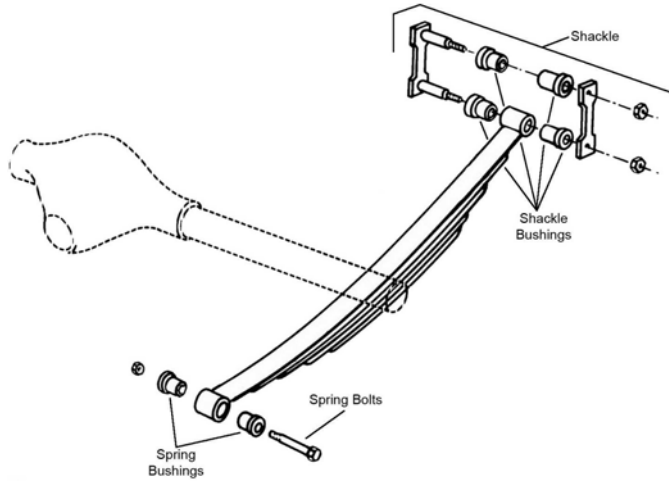

R309

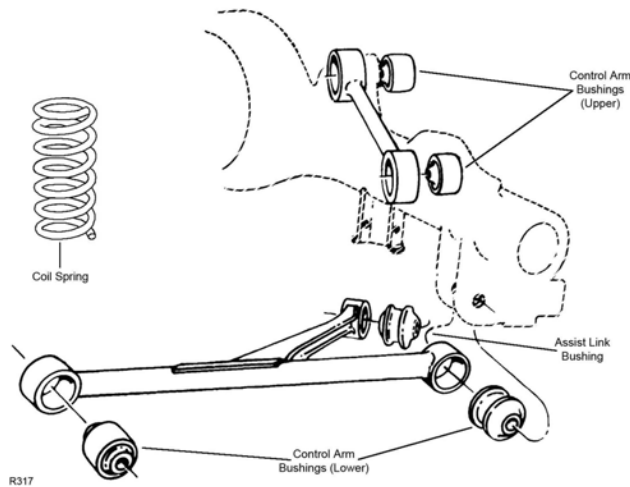

R317

Year	Model/Application	Part	P/C Qty	Figure
Control Arm Bushing				
1983-1979	Lower Rear Inner	K201069	2	R317
1980-1978	Lower Rear Outer	K201036	2	R317
Leaf Spring Bolt Kit				
1973-1970		K150236	2	R309
Leaf Spring Bushing				
1973-1972	(Heavy Duty) Fixed End	K200958	2	R309
Leaf Spring Shackle Bushing				
1974-1970	(Split Type Bushing)	K7308	4	R309

FRONT SUSPENSION

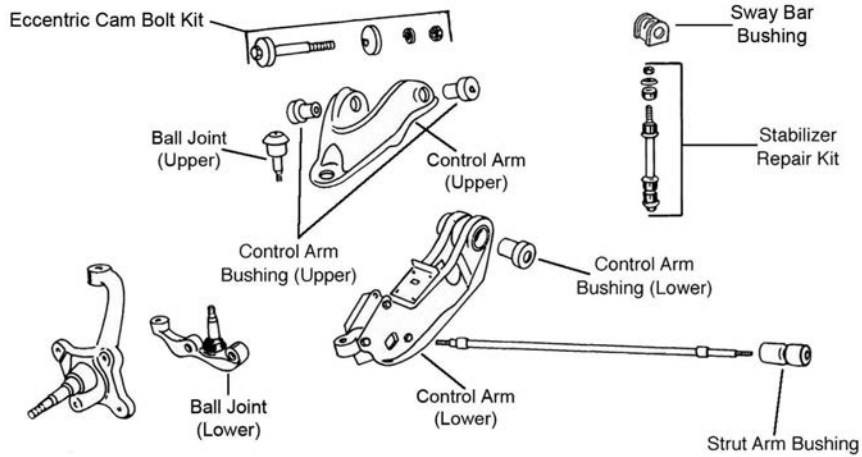

F124

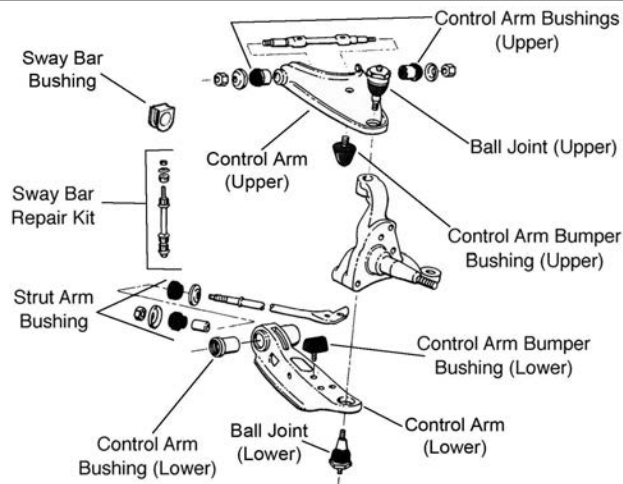

F125

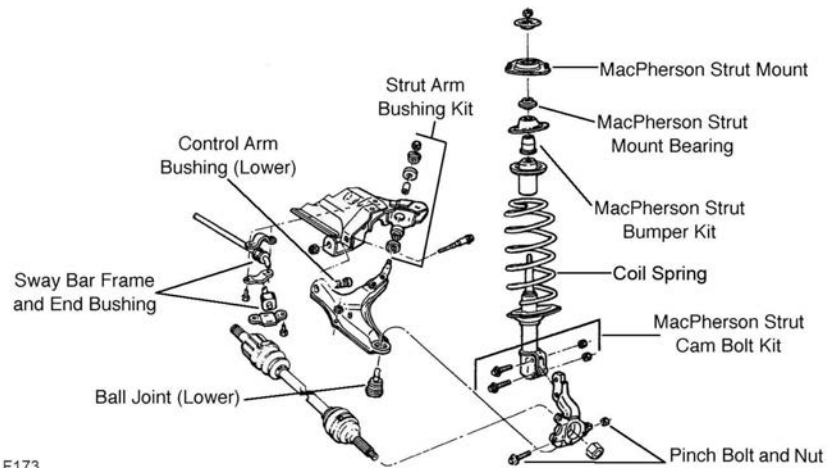

F173

Year	Model/Application	Part	P/C Qty	Figure
Ball Joint				
1987-1984	(Full Ball Stud Provides 360 Degrees Of Smooth Rotation)	Lower K7147 ‡	2	F173
1983	(Full Ball Stud Provides 360 Degrees Of Smooth Rotation)	Lower K7115 ‡	2	F173
1978-1974	(Press In Type, Powdered Metal Gusher Brg. For Better Lubrication)	Lower K7069 ‡	2	F125
1978-1973	(Powdered Metal Gusher Brg. For Better Lubrication)	Upper K772 ‡	2	F125
1973	(Threaded Type, Powdered Metal Gusher Brg. For Better Lubrication)	Lower K719 ‡	2	F125
1972-1966	(Powdered Metal Gusher Brg. For Better Lubrication) (Powdered Metal Gusher Brg. For Better Lubrication)	Upper K772 ‡	2	F124
		Left Lower K783 ‡	1	F124

DODGE-Charger (Cont.)

FRONT SUSPENSION (Cont.)					
Year	Model/Application	Part	P/C Qty	Figure	
Ball Joint					
1972-1966 (Cont.)	(Powdered Metal Gusher Brg. For Better Lubrication)	Right Lower	K781 ‡	1	F124
Control Arm Bumper Bushing					
1978-1973		Upper	K7293	2	F125
1972-1970		Upper	K7293	2	F124
1972-1968		Lower	K3180	2	F124
Control Arm Bushing					
1987-1983		Lower	K7099	2	F173
1978-1973	(Contains Front And Rear Bushings)	Upper Lower	K7058 K7059	2 2	F125 F125
1972-1966	(Optional, Eccentric Bushing, Provides Additional Positive(+) Camber Adjustment) (Standard Design, Contains Front And Rear Bushings)	Upper Upper Lower	K7103 K408 K791	2 1 2	F124 F124 F124
Control Arm with Ball Joint					
1987-1984	(R-Series) (R-Series)	Left Lower Right Lower	RK621311 RK621312	1 1	F173 F173
Strut Bumper Bellows					
1987-1983	(Replacement Type, Contains Bumper)		K90460	2	F173
Strut Mount					
1987-1983	(Contains Bearing, Contains Spacer)		K7179	2	F173
Strut Rod Bushing					
1987-1983	(Improved Design)	To Frame	K7098	1	F173
Strut Rod Bushing Kit					
1987-1984	(Improved Design)		K7145	1	F173
1974	Thru 10/18/73, Except Police Or Taxi, (Improved Design) Thru 10/18/73, Taxi, (Improved Design) Thru 10/18/73, Taxi, (Standard Design)		K7068 K7026 K7016A	1 1 1	F125 F125 F125
1974-1973	Police, (Improved Design) Police, (Standard Design)		K7026 K7016A	1 1	F125 F125
1973	Except Police Or Taxi, (Improved Design) Taxi, (Improved Design) Taxi, (Standard Design)		K7068 K7026 K7016A	1 1 1	F125 F125 F125
1972-1966	(Improved Design) (Standard Design)		K7026 K7016A	1 1	F124 F124
Sway Bar Bushing					
1987-1984	1" Sway Bar Diameter 1-1/16" Sway Bar Diameter 1-1/16" Sway Bar Diameter 1-1/8" Sway Bar Diameter 1-3/16" Sway Bar Diameter 15/16" Sway Bar Diameter 3/4" Sway Bar Diameter 7/8" Sway Bar Diameter	To Frame To Arm To Frame To Frame To Frame To Frame To Frame To Frame	K7139 K7219 K7222 K7223 K7224 K7138 K7221 K7137	1 1 1 1 1 1 1 1	F173 F173 F173 F173 F173 F173 F173 F173
1983	1" Sway Bar Diameter, (Contains Thermoplastic Bushings And Universal Mounting Bracket) 15/16" Sway Bar Diameter 7/8" Sway Bar Diameter 7/8" Sway Bar Diameter	To Frame To Arm To Arm To Frame	K8793 ‡ K7143 K7142 K7135	1 1 1 1	F173 F173 F173 F173
1978-1975		To Frame To Strut Rod	K7062 K7064	1 1	F125 F125
1974	Except Police	To Frame	K7061	1	F125
1974-1973	Except Police	To Strut Rod	K7064	1	F125
1973		To Frame	K7061	1	F125
1972-1970	15/16" Sway Bar Diameter	To Frame	K5241	1	F124
Sway Bar Repair Kit					
1969-1966	(Heavy Duty Design) (Includes Polyurethane Bushings And Solid Metal Sleeve For Enhanced Performance. Barrel Nut Allows For Easier Installation.) (Standard Design)		K6629 ‡ K700535 ‡ K8266	2 2 2	F124 F124 F124
Wheel Hub Repair Kit					
1987	Naturally Aspirated Turbocharged, (4 Stud Hub) Turbocharged, (5 Stud Hub)		518500 518501 518502	2 2 2	

STEERING

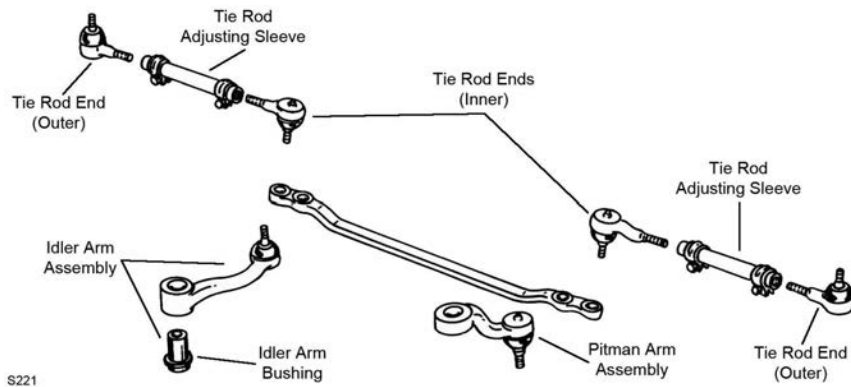

S221

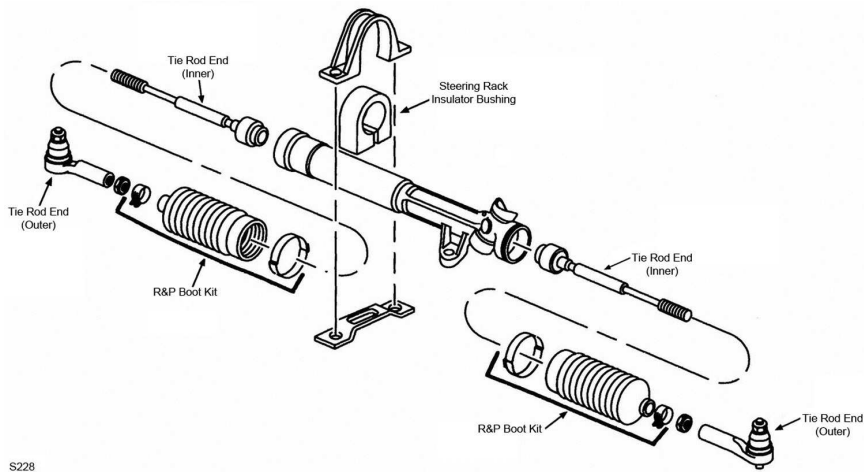

S228

Year	Model/Application	Part	P/C Qty	Figure
Idler Arm				
1978-1973	(Powdered Metal Gusher Brg. For Better Lubrication)	K7066 ‡	1	S221
1972-1968	(Powdered Metal Gusher Brg. For Better Lubrication)	K7041 ‡	1	S221
1967-1966	(Powdered Metal Gusher Brg. For Better Lubrication)	K779 ‡	1	S221
Pitman Arm				
1978-1973	Power Steering, (Greaseable Socket Reduces Corrosion/Wear)	K7076 ‡	1	S221
Rack & Pinion Boot Kit				
1987	Rack Marked 7846704, Power Steering	Left K6298	1	S228
	Saginaw Rack Marked 7841002, Power Steering	Left K6298	1	S228
	TRW Rack Marked 25-6, Power Steering, (High Temperature)	K8441	2	S228
1986-1983	Power Steering	Left K6298	1	S228
Steering Rack Insulator Bushing				
1987-1983	Power Steering	K7113	1	S228
Tie Rod Adjusting Sleeve				
1978-1973		ES430S	2	S221
1972-1966		ES319S	2	S221
Tie Rod End				
1987	Base Model, Internally Threaded Racks, Manual Steering, (Full Ball Stud Provides 360 Degrees Of Smooth Rotation)	Inner EV126 ‡	2	S228
1987-1986	Rack & Pinion Power, Saginaw Design Rack And Pinion Gear, (Full Ball Stud Provides 360 Degrees Of Smooth Rotation)	Inner EV116 ‡	2	S228
	Rack & Pinion Power, TRW Design Rack And Pinion Gear, (Full Ball Stud Provides 360 Degrees Of Smooth Rotation)	Inner EV128 ‡	2	S228
1987-1983	(Powdered Metal Gusher Brg. For Better Lubrication)	Outer ES3008RL ‡	2	S228
1986-1984	2.2, Base Model, Internally Threaded Racks, Manual Steering, (Full Ball Stud Provides 360 Degrees Of Smooth Rotation)	Inner EV126 ‡	2	S228
1985-1983	Rack & Pinion Power, (Full Ball Stud Provides 360 Degrees Of Smooth Rotation)	Inner EV116 ‡	2	S228
1983	Internally Threaded Racks, Manual Steering, (Full Ball Stud Provides 360 Degrees Of Smooth Rotation)	Inner EV126 ‡	2	S228

DODGE-Charger (Cont.)

STEERING (Cont.)

Year	Model/Application	Part	P/C Qty	Figure	
Tie Rod End					
1978-1970	(Right Hand Threads, Powdered Metal Gusher Brg. For Better Lubrication) (Left Hand Threads, Powdered Metal Gusher Brg. For Better Lubrication)	Outer	ES401R ‡	2	S221
		Inner	ES401L ‡	2	S221
1969-1966	(Powdered Metal Gusher Brg. For Better Lubrication) (Powdered Metal Gusher Brg. For Better Lubrication)	Outer	ES319R ‡	2	S221
		Inner	ES319L ‡	2	S221

REAR SUSPENSION

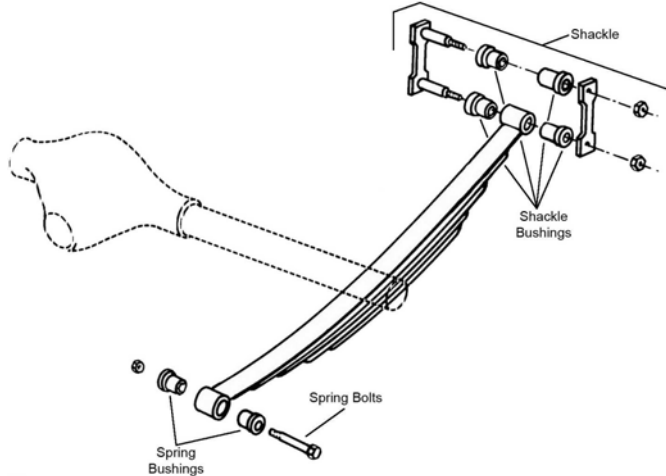

R309

Year	Model/Application	Part	P/C Qty	Figure
Leaf Spring Bolt Kit				
1973-1966		K150236	2	R309
Leaf Spring Bushing				
1978-1974	Fixed End	SB364	2	R309
Leaf Spring Shackle Bushing				
1978-1966	(Split Type Bushing)	K7308	4	R309

DODGE-Colt

FRONT SUSPENSION

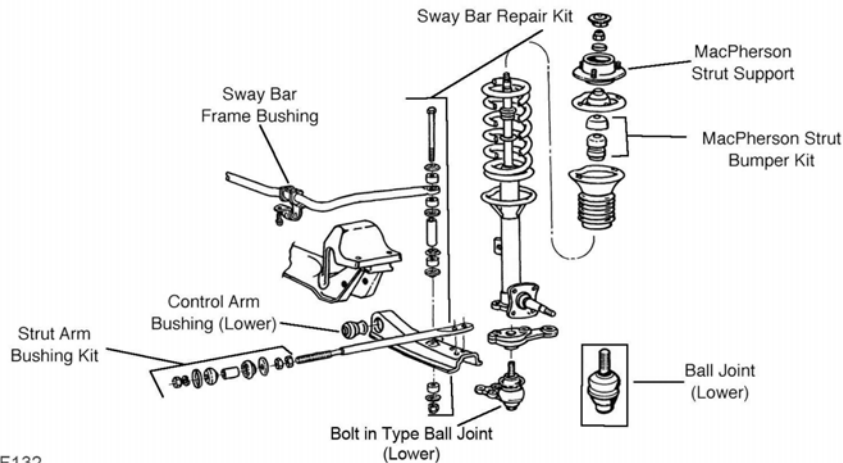

F132

F132