

FRONT SUSPENSION				
Year	Model/Application	Part	P/C Qty	Figure
Ball Joint				
1958-1957	(Powdered Metal Gusher Brg. For Better Lubrication) (Threaded Type, Powdered Metal Gusher Brg. For Better Lubrication)	Upper Lower	K772 ‡ K719 ‡	2 2
Strut Rod Bushing				
1958-1957	(Improved Design)		K7039	1
STEERING				
Year	Model/Application	Part	P/C Qty	Figure
Tie Rod Adjusting Sleeve				
1958-1957	11/16" - 18 Thread, 4.72" Length		ES2004S	1

FRONT SUSPENSION				
Year	Model/Application	Part	P/C Qty	Figure
Ball Joint				
1959	(Powdered Metal Gusher Brg. For Better Lubrication) (Threaded Type, Powdered Metal Gusher Brg. For Better Lubrication)	Upper Lower	K772 ‡ K719 ‡	2 2
Control Arm Bushing				
1959	(Contains Front And Rear Bushings)	Upper	K325	1
Strut Rod Bushing				
1959	(Improved Design)		K7039	1
STEERING				
Year	Model/Application	Part	P/C Qty	Figure
Tie Rod Adjusting Sleeve				
1959	11/16" - 18 Thread, 4.72" Length		ES2004S	1

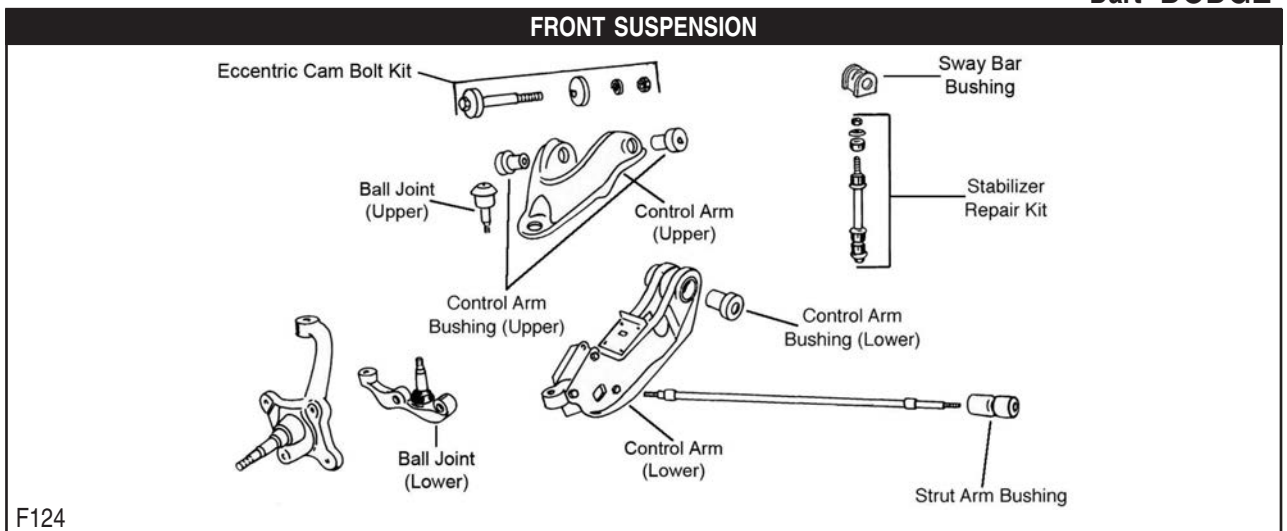

DODGE-Dart (Cont.)

FRONT SUSPENSION (Cont.)

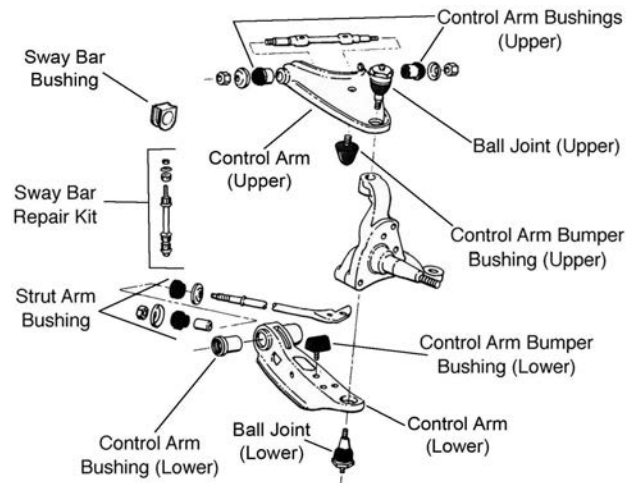

F125

Year	Model/Application	Part	P/C Qty	Figure
Ball Joint				
1976-1973	(Powdered Metal Gusher Brg. For Better Lubrication) (Powdered Metal Gusher Brg. For Better Lubrication) (Powdered Metal Gusher Brg. For Better Lubrication)	Upper Left Lower Right Lower	K772 ‡ K783 ‡ K781 ‡	2 1 1 F124 F124 F124
1972-1965	Front Disc, (Powdered Metal Gusher Brg. For Better Lubrication) Front Disc, (Powdered Metal Gusher Brg. For Better Lubrication)	Left Lower Right Lower	K7023 ‡ K7021 ‡	1 1 F124 F124
1972-1963	(Powdered Metal Gusher Brg. For Better Lubrication) Front Drum, (Powdered Metal Gusher Brg. For Better Lubrication) Front Drum, (Powdered Metal Gusher Brg. For Better Lubrication)	Upper Left Lower Right Lower	K704 ‡ K787 ‡ K785 ‡	2 1 1 F124 F124 F124
1962	(Powdered Metal Gusher Brg. For Better Lubrication) (Powdered Metal Gusher Brg. For Better Lubrication) (Powdered Metal Gusher Brg. For Better Lubrication)	Upper Left Lower Right Lower	K772 ‡ K783 ‡ K781 ‡	2 1 1 F124 F124 F124
1961-1960	(Powdered Metal Gusher Brg. For Better Lubrication) (Threaded Type, Powdered Metal Gusher Brg. For Better Lubrication)	Upper Lower	K772 ‡ K719 ‡	2 2 F125 F125
Control Arm Bumper Bushing				
1976-1970		Upper	K7293	2 F124
1976-1965		Lower	K3180	2 F124
Control Arm Bushing				
1976-1962	(Contains Front And Rear Bushings)	Upper Lower	K408 K791	1 2 F124 F124
1961-1960	(Contains Front And Rear Bushings)	Upper	K325	1 F125
Strut Rod Bushing				
1962			K7039	1 F124
1961-1960			K7039	1 F125
Strut Rod Bushing Kit				
1976-1973	(Improved Design)		K7068	1 F124
1972-1963	(Improved Design)		K7040	1 F124
Sway Bar Bushing				
1976-1973	15/16" Sway Bar Diameter	To Frame	K5241	1 F124
Sway Bar Repair Kit				
1976-1975	(OEM Type, Standard Design)		K5255	2 F124
1976-1973	(Heavy Duty Design) 5.5" Length, (Includes Polyurethane Bushings And Solid Metal Sleeve For Enhanced Performance. Barrel Nut Allows For Easier Installation.)		K8989 ‡ K700528 ‡	2 2 F124 F124
1972-1965	(Heavy Duty Design) (Includes Polyurethane Bushings And Solid Metal Sleeve For Enhanced Performance. Barrel Nut Allows For Easier Installation.) (Standard Design)		K6629 ‡ K700535 ‡ K8266	2 2 2 F124 F124 F124

STEERING

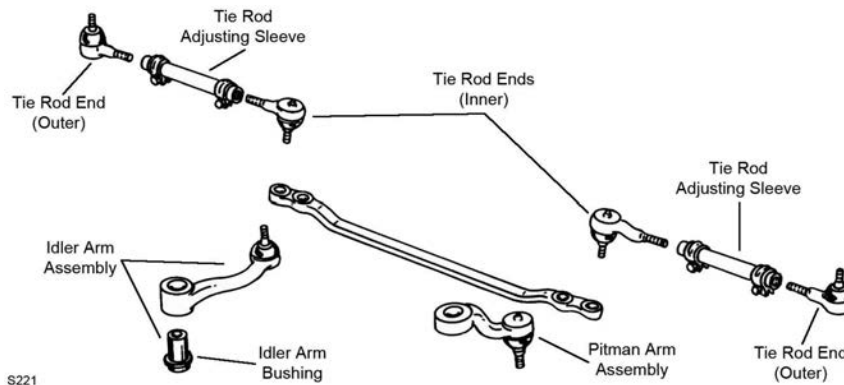

S221

Year	Model/Application	Part	P/C Qty	Figure
Idler Arm				
1976-1973	Except Police Or Taxi, (Powdered Metal Gusher Brg. For Better Lubrication)	K7086 ‡	1	S221
1972-1968	(Powdered Metal Gusher Brg. For Better Lubrication)	K7042 ‡	1	S221
1962	(Powdered Metal Gusher Brg. For Better Lubrication)	K779 ‡	1	S221
Pitman Arm				
1976-1973	Manual Steering, (Greaseable Socket Reduces Corrosion/Wear)	K7075 ‡	1	S221
	Power Steering, (Greaseable Socket Reduces Corrosion/Wear)	K7076 ‡	1	S221
1972-1970	(Greaseable Socket Reduces Corrosion/Wear)	K7074 ‡	1	S221
1969-1968	318(5.2L), (Greaseable Socket Reduces Corrosion/Wear)	K7074 ‡	1	S221
	340(5.6L), (Greaseable Socket Reduces Corrosion/Wear)	K7074 ‡	1	S221
1969-1967	170(2.8L), (Greaseable Socket Reduces Corrosion/Wear)	K7074 ‡	1	S221
	225(3.7L), (Greaseable Socket Reduces Corrosion/Wear)	K7074 ‡	1	S221
	273(4.5L), (Greaseable Socket Reduces Corrosion/Wear)	K7074 ‡	1	S221
Tie Rod Adjusting Sleeve				
1976-1962		ES319S	2	S221
1961-1960		ES2004S	2	S221
Tie Rod End				
1976-1970	(Right Hand Threads, Powdered Metal Gusher Brg. For Better Lubrication)	Outer ES401R ‡	2	S221
	(Left Hand Threads, Powdered Metal Gusher Brg. For Better Lubrication)	Inner ES401L ‡	2	S221
1969-1962	(Powdered Metal Gusher Brg. For Better Lubrication)	Outer ES319R ‡	2	S221
	(Powdered Metal Gusher Brg. For Better Lubrication)	Inner ES319L ‡	2	S221

REAR SUSPENSION

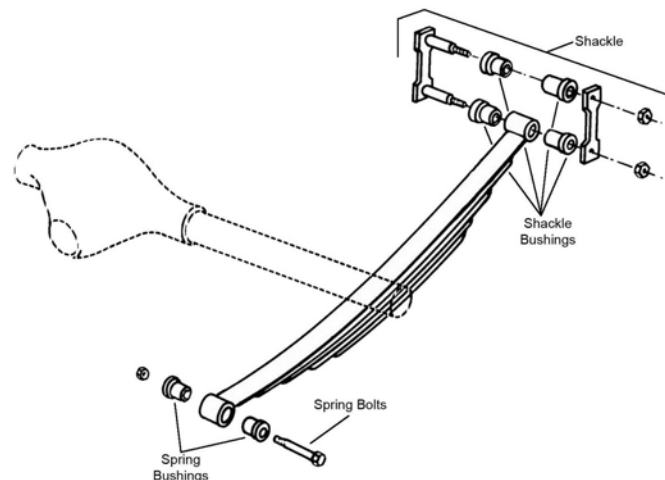

R309

Year	Model/Application	Part	P/C Qty	Figure
Leaf Spring Bolt Kit				
1973-1968	318(5.2L)	K150236	2	R309
	340(5.6L)	K150236	2	R309
1969-1964	273(4.5L)	K150236	2	R309
1962-1960		K150236	2	R309

DODGE-Dart (Cont.)

REAR SUSPENSION (Cont.)

Year	Model/Application	Part	P/C Qty	Figure
Leaf Spring Bushing				
1976-1975	Fixed End	K200998	2	R309
Leaf Spring Shackle				
1976-1971		K150239	2	R309
Leaf Spring Shackle Bushing				
1976-1963		K7309	4	R309

DODGE-Daytona

FRONT SUSPENSION

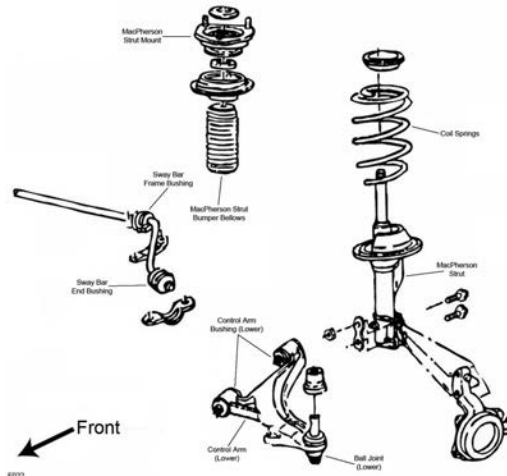

F022

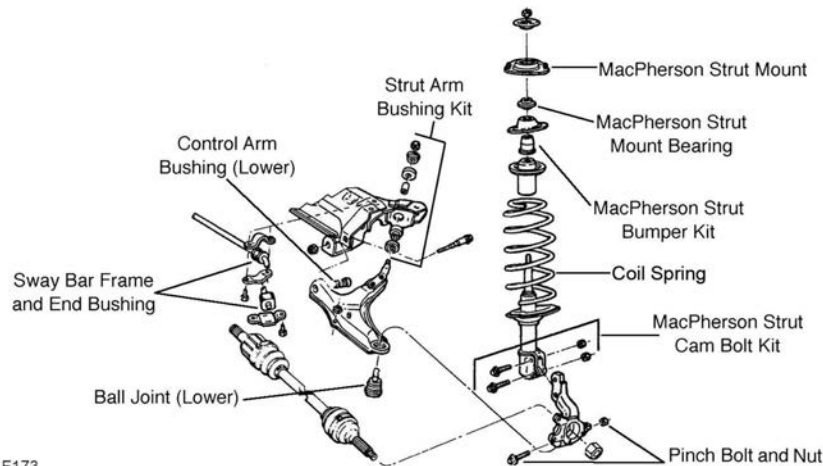

F173

Year	Model/Application	Part	P/C Qty	Figure
Ball Joint				
1990-1989	(Full Ball Stud Provides 360 Degrees Of Smooth Rotation)	Lower	K7147 ‡	2 F022
1988-1984	(Full Ball Stud Provides 360 Degrees Of Smooth Rotation)	Lower	K7147 ‡	2 F173
Control Arm Bushing				
1988-1984		Lower	K7099	2 F173
Control Arm with Ball Joint				
1988-1985	Standard Suspension, (R-Series)	Left Lower	RK621311	1 F173
	Standard Suspension, (R-Series)	Right Lower	RK621312	1 F173
Strut Bearing Spacer				
1990-1989	(Spacer)		K7378	2 F022
1988-1987	(Spacer)		K7378	2 F173
1986	From 1/2/86, (Spacer)		K7378	2 F173