

# PORSCHE TRUCK–Macan (Cont.)

## FRONT SUSPENSION (Cont.)

Year	Model/Application	Part	P/C Qty	Figure
<b>Control Arm with Ball Joint</b>				
2018-2015 (Cont.)	(R-Series) Right Rear Upper	RK621124	1	
<b>Strut Mount</b>				
2017-2015	Except Active Suspension, (Bearing Not Included, Contains Washer)	K160365	2	
<b>Sway Bar Bushing</b>				
2018-2017	4 Cyl To Frame	K201343	1	
<b>Sway Bar Link</b>				
2018-2015	(Durable, All Metal Construction For Longer Life)	K750359 ‡	2	
<b>Wheel Bearing Assembly</b>				
2018-2015		512574	2	

## STEERING

Year	Model/Application	Part	P/C Qty	Figure
<b>Tie Rod End</b>				
2018-2015	(Design Allows Ease Of Installation) (Design Allows Ease Of Installation)	Left Outer Right Outer Inner	ES800670 ‡ ES800671 ‡ EV801035	1 1 2

## REAR SUSPENSION

Year	Model/Application	Part	P/C Qty	Figure
<b>Control Arm</b>				
2018-2015	(R-Series) (R-Series)	Left Upper Right Upper	RK642745 RK642746	1 1
<b>Shock Mount</b>				
2017-2015	Except Active Suspension	K160284	2	
<b>Sway Bar Link</b>				
2018-2015		K700804	2	
<b>Wheel Bearing Assembly</b>				
2018-2015		512574	2	

# RAM TRUCK–1500

## FRONT SUSPENSION

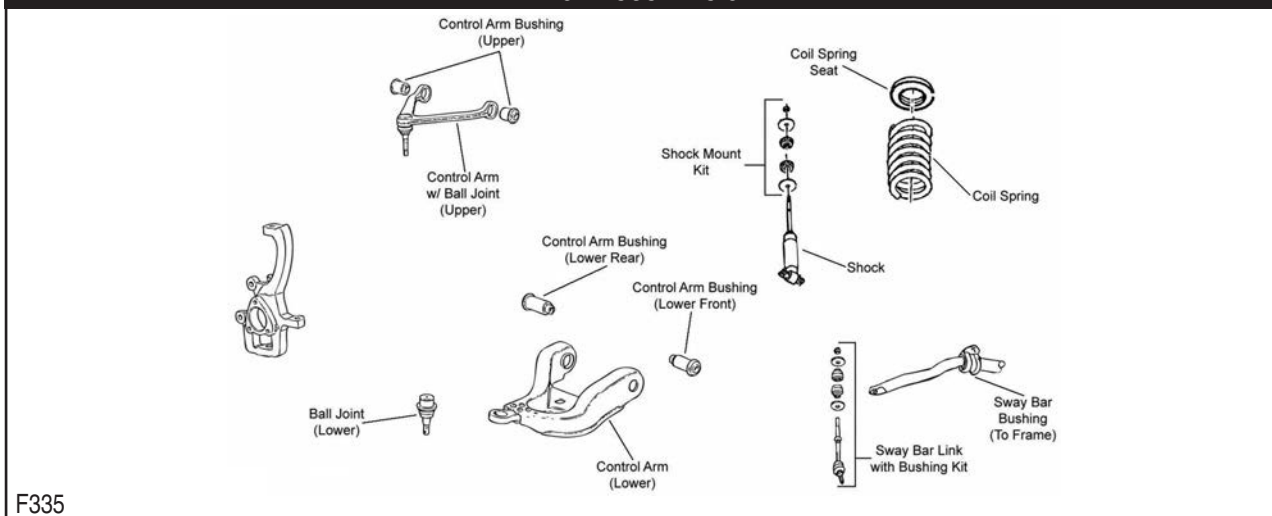

**FRONT SUSPENSION (Cont.)**

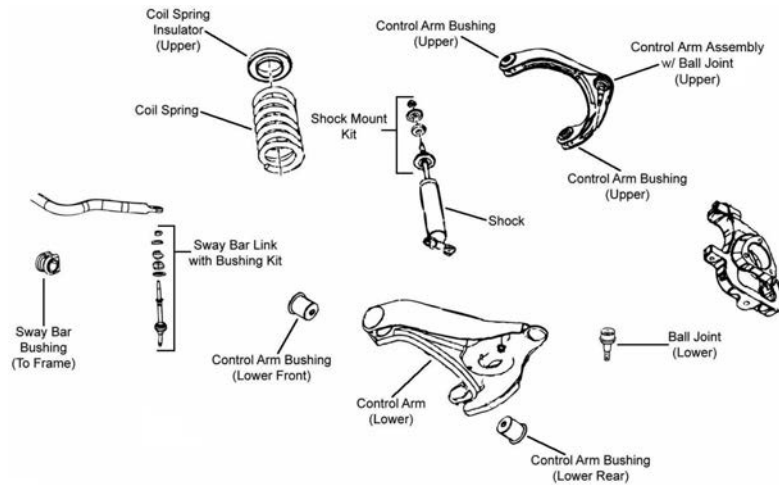

F338

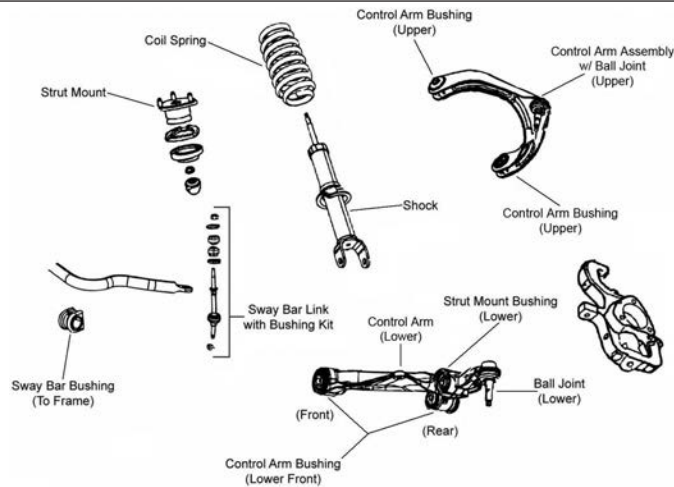

F339

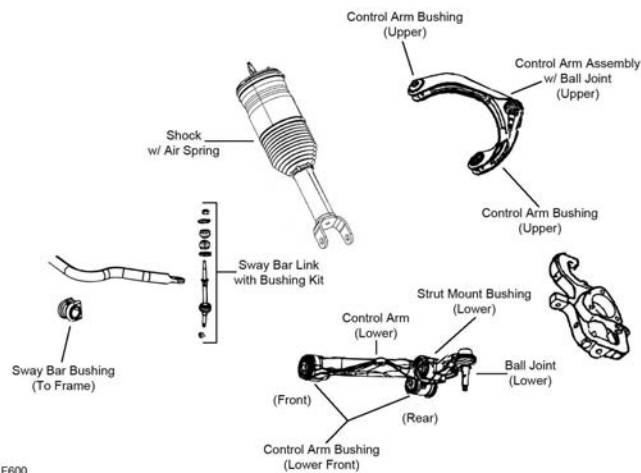

F600

Year	Model/Application	Part	P/C Qty	Figure	
<b>Ball Joint</b>					
2018-2017	Plus Or Minus 2-1/4 Degree Camber And/Or Caster, (Adjustable)	Upper	K100316	2	F338, F339, F600
2018-2013	Plus Or Minus 3 Degrees Camber/Caster, (Adjustable, Greaseable Socket Reduces Corrosion/Wear) Four Wheel Drive (4X4), (Press In Type, Design Allows Ease Of Installation) Two Wheel Drive (4x2), Air Suspension, (Press In Type, Design Allows Ease Of Installation)	Upper	K100115 ‡	2	F338, F339, F600
		Lower	K500286 ‡	2	F339, F600
		Lower	K500286 ‡	2	F600

# RAM TRUCK-1500 (Cont.)

## FRONT SUSPENSION (Cont.)

Year	Model/Application	Part	P/C Qty	Figure
<b>Ball Joint</b>				
2016-2013	Plus Or Minus 2-1/4 Degree Camber And/Or Caster, (Adjustable)	Upper	K100316	2 F338, F339, F600
2012	5 Lug Wheels, Plus Or Minus 2-1/4 Degree Camber And/Or Caster, (Adjustable)	Upper	K100316	2 F338, F339
	5 Lug Wheels, Plus Or Minus 3 Degrees Camber/Caster, (Adjustable, Greaseable Socket Reduces Corrosion/Wear)	Upper	K100115 ‡	2 F338, F339
	Two Wheel Drive (4x2), 5 Lug Wheels, (Powdered Metal Gusher Brg. For Better Lubrication, New Pre-Installed Integral Dust Boot Eases Installation, New And Original Designs Can Be Installed)	Lower	K7411 ‡	2 F338
2012-2011	Four Wheel Drive (4X4), (Press In Type, Design Allows Ease Of Installation)	Lower	K500286 ‡	2 F339
2011	Plus Or Minus 2-1/4 Degree Camber And/Or Caster, (Adjustable)	Upper	K100316	2 F338, F339
	Plus Or Minus 3 Degrees Camber/Caster, (Adjustable, Greaseable Socket Reduces Corrosion/Wear)	Upper	K100115 ‡	2 F338, F339
	Two Wheel Drive (4x2), (Powdered Metal Gusher Brg. For Better Lubrication, New Pre-Installed Integral Dust Boot Eases Installation, New And Original Designs Can Be Installed)	Lower	K7411 ‡	2 F338
<b>Control Arm Bushing</b>				
2018-2017	Four Wheel Drive (4X4), (Split Design For Easier Installation)	At Shock	K200688 ‡	2 F339, F600
2018-2014	Two Wheel Drive (4x2), Air Suspension, (Split Design For Easier Installation)	At Shock	K200688 ‡	2 F600
2015-2013	Four Wheel Drive (4X4), (Split Design For Easier Installation)	At Shock	K200688 ‡	2 F339, F600
2013	Four Wheel Drive (4X4), (High Quality Elastomer For Durability And Performance)	Lower Rear	K200184 ‡	2 F339, F600
	Four Wheel Drive (4X4), (High Quality Elastomer For Durability And Performance)	Lower Front	K200185 ‡	2 F339, F600
2012	8 Lug Wheels, (Contains Front And Rear Bushings)	Upper	K200115 ‡	2 F335
	Two Wheel Drive (4x2), 8 Lug Wheels, (High Quality Elastomer For Durability And Performance)	Lower	K200114 ‡	2 F335
2012-2011	Four Wheel Drive (4X4), (High Quality Elastomer For Durability And Performance)	Lower Rear	K200184 ‡	2 F339
	Four Wheel Drive (4X4), (High Quality Elastomer For Durability And Performance)	Lower Front	K200185 ‡	2 F339
	Four Wheel Drive (4X4), (Split Design For Easier Installation)	At Shock	K200688 ‡	2 F339
<b>Control Arm with Ball Joint</b>				
2018-2015	Four Wheel Drive (4X4), (R-Series, Replaces Steel Or Aluminum Arm)	Left Lower	RK641504	1
	Four Wheel Drive (4X4), (R-Series, Replaces Steel Or Aluminum Arm)	Right Lower	RK621602	1
	Two Wheel Drive (4x2), Air Suspension, (R-Series, Replaces Steel Or Aluminum Arm)	Left Lower	RK641504	1
	Two Wheel Drive (4x2), Air Suspension, (R-Series, Replaces Steel Or Aluminum Arm)	Right Lower	RK621602	1
2018-2013	Front Coil Spring Suspension, (Forged Arm, R-Series)	Left Upper	RK620634	1 F338, F339, F600
	Front Coil Spring Suspension, (Forged Arm, R-Series)	Right Upper	RK621897	1 F338, F339, F600
	Two Wheel Drive (4x2), Front Coil Spring Suspension	Left Lower	RK623101	1 F338
	Two Wheel Drive (4x2), Front Coil Spring Suspension	Right Lower	RK623100	1 F338
2018-2011	Air Suspension, (Stamped Steel Arm)	Left Upper	RK643074	1 F338, F339, F600
2016-2013	Four Wheel Drive (4X4), (R-Series, Replaces Steel Or Aluminum Arm)	Left Lower	RK641504	1 F339, F600
	Four Wheel Drive (4X4), (R-Series, Replaces Steel Or Aluminum Arm)	Right Lower	RK621602	1 F339, F600
	Two Wheel Drive (4x2), Air Suspension, (R-Series, Replaces Steel Or Aluminum Arm)	Left Lower	RK641504	1 F600
	Two Wheel Drive (4x2), Air Suspension, (R-Series, Replaces Steel Or Aluminum Arm)	Right Lower	RK621602	1 F600
2014-2013	(Forged Arm, R-Series)	Left Upper	RK620634	1 F338, F339, F600
	(Forged Arm, R-Series)	Right Upper	RK621897	1 F338, F339, F600
2014-2011	(Stamped Steel Arm)	Left Upper	RK643074	1 F338, F339, F600
2012	8 Lug Wheels, (Contains Bushings, Powdered Metal Gusher Brg. For Better Lubrication)	Upper	CK620181 ‡	2 F335
	8 Lug Wheels, (Contains Bushings, R-Series)	Upper	RK620181	2 F335
	Two Wheel Drive (4x2), 5 Lug Wheels, (R-Series)	Left Lower	RK621606	1 F338
	Two Wheel Drive (4x2), 5 Lug Wheels, (R-Series)	Right Lower	RK621605	1 F338
	Two Wheel Drive (4x2), 8 Lug Wheels, (R-Series)	Left Lower	RK621265	1 F335
	Two Wheel Drive (4x2), 8 Lug Wheels, (R-Series)	Right Lower	RK621264	1 F335
2012-2011	(Forged Arm, R-Series)	Left Upper	RK620634	1 F338, F339
	(Forged Arm, R-Series)	Right Upper	RK621897	1 F338, F339
	Four Wheel Drive (4X4), (R-Series, Replaces Steel Or Aluminum Arm)	Left Lower	RK641504	1 F339
	Four Wheel Drive (4X4), (R-Series, Replaces Steel Or Aluminum Arm)	Right Lower	RK621602	1 F339
2011	Two Wheel Drive (4x2), (R-Series)	Left Lower	RK621606	1 F338
	Two Wheel Drive (4x2), (R-Series)	Right Lower	RK621605	1 F338
<b>Strut and Spring Assembly</b>				
2015	Four Wheel Drive (4X4), (Strut, Spring & Top Mount)		ST8606	2 F339
2014-2011	Four Wheel Drive (4X4), Except Air Suspension, (Strut, Spring & Top Mount)		ST8606	2 F339
<b>Strut Bumper Bellows</b>				
2016-2013	Four Wheel Drive (4X4), Except Air Suspension		K201301	2 F339
2012-2011	Four Wheel Drive (4X4)		K201301	2 F339
<b>Strut Bushing</b>				
2016-2013	Four Wheel Drive (4X4)	Lower	K160326	2 F339, F600

FRONT SUSPENSION (Cont.)				
Year	Model/Application	Part	P/C Qty	Figure
<b>Strut Bushing</b>				
2012-2011	Four Wheel Drive (4X4) Lower	K160326	2	F339
<b>Strut Mount</b>				
2016-2013	Four Wheel Drive (4X4), Except Air Suspension, (Contains Spring Seat And Insulator, Superior Rubber To Steel Bonding For Durability)	K160196 ‡	2	F339
2012-2011	Four Wheel Drive (4X4), (Contains Spring Seat And Insulator, Superior Rubber To Steel Bonding For Durability)	K160196 ‡	2	F339
<b>Sway Bar Bushing</b>				
2018-2013	Four Wheel Drive (4X4), 32mm Sway Bar Diameter, (Improved Design Bushing With Premium Rubber Material And Synthetic Fabric Lining Lasts Longer And Eliminates Noise) Four Wheel Drive (4X4), 32mm Sway Bar Diameter, (Standard Design) Four Wheel Drive (4X4), 36.8mm Sway Bar Diameter	To Frame K201621 ‡	1	F339, F600
		To Frame K7353	1	F339, F600
		To Frame K7384	1	F339, F600
2012-2011	Four Wheel Drive (4X4), 32mm Sway Bar Diameter, (Improved Design Bushing With Premium Rubber Material And Synthetic Fabric Lining Lasts Longer And Eliminates Noise) Four Wheel Drive (4X4), 32mm Sway Bar Diameter, (Standard Design) Four Wheel Drive (4X4), 36.8mm Sway Bar Diameter	To Frame K201621 ‡	1	F339
		To Frame K7353	1	F339
		To Frame K7384	1	F339
<b>Sway Bar Link</b>				
2017-2013	(Powdered Metal Gusher Brg. For Better Lubrication)	K80894 ‡	2	F338, F339, F600
2013-2011	Two Wheel Drive (4x2), (Optional, Powdered Metal Gusher Brg. For Better Lubrication)	K7400 ‡	2	F338
	Two Wheel Drive (4x2), (Powdered Metal Gusher Brg. For Better Lubrication)	K750157 ‡	2	F338
2012-2011	Four Wheel Drive (4X4), (Powdered Metal Gusher Brg. For Better Lubrication)	K80894 ‡	2	F339
<b>Sway Bar Repair Kit</b>				
2012-2011	(Bushing Kit)	K7300	2	F338, F339
<b>Wheel Hub &amp; Bearing Assembly</b>				
2018-2012		515151	2	
2011	5 Stud Wheel	515126	2	
<b>STEERING</b>				
<p>S094</p>				
<p>S322</p>				
Year	Model/Application	Part	P/C Qty	Figure
<b>Tie Rod End</b>				
2018	(Powdered Metal Gusher Brg. For Better Lubrication)	Outer ES801123 Inner EV800958 ‡	2 2	
2017-2013	(Powdered Metal Gusher Brg. For Better Lubrication)	Outer ES801123	2	S322
		Inner EV800958 ‡	2	S322
2012	5 Lug Wheels, (Powdered Metal Gusher Brg. For Better Lubrication) 5 Lug Wheels, (Powdered Metal Gusher Brg. For Better Lubrication) 8 Lug Wheels, (Full Ball Stud Provides 360 Degrees Of Smooth Rotation)	Outer ES80574 ‡	2	S094
		Inner EV800098 ‡	2	S094
		Inner EV80211 ‡	2	S094
2011	(Powdered Metal Gusher Brg. For Better Lubrication) (Powdered Metal Gusher Brg. For Better Lubrication)	Outer ES80574 ‡	2	S094
		Inner EV800098 ‡	2	S094

# RAM TRUCK-1500 (Cont.)

## REAR SUSPENSION

Year	Model/Application	Part	P/C Qty	Figure
<b>Control Arm</b>				
2018-2013	(R-Series)	Upper	RK642932	2
2012-2011	(R-Series)	Upper	RK642211	2
		Lower	RK643104	2
<b>Sway Bar Link</b>				
2018-2011	(Full Ball Stud Provides 360 Degrees Of Smooth Rotation)	K750396 ‡	2	
<b>Track Bar</b>				
2018-2011	(R-Series)	RK661215	1	

# RAM TRUCK-1500 Classic

## FRONT SUSPENSION

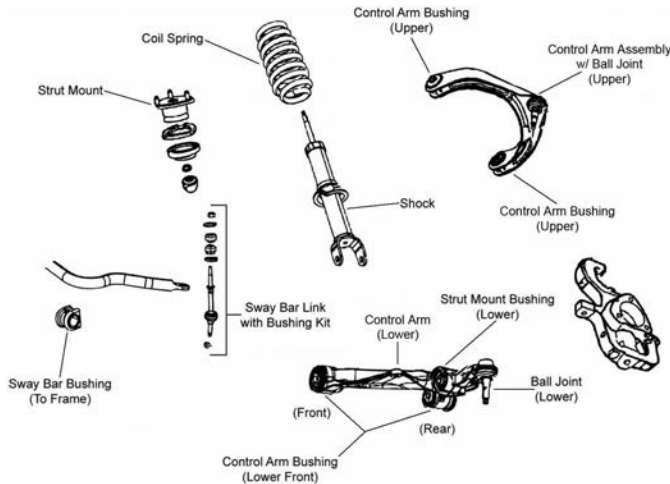

F339

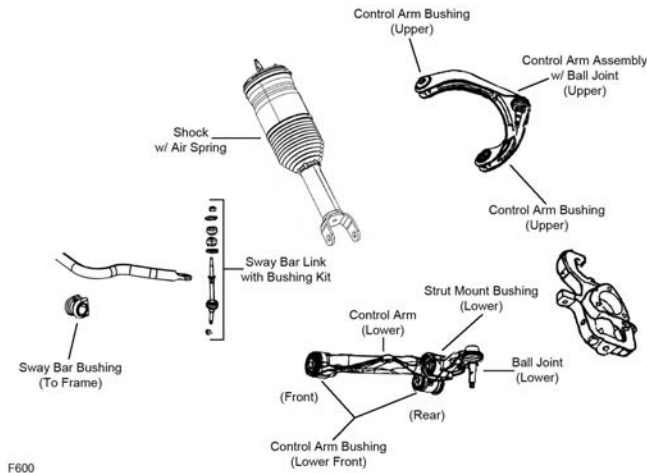

F600

Year	Model/Application	Part	P/C Qty	Figure
<b>Ball Joint</b>				
2019	Four Wheel Drive (4X4), (Press In Type, Design Allows Ease Of Installation)	Lower	K500286 ‡	2
<b>Control Arm Bushing</b>				
2019	Four Wheel Drive (4X4), (Split Design For Easier Installation)	Lower	K200688 ‡	2
<b>Control Arm with Ball Joint</b>				
2019	Four Wheel Drive (4X4), (R-Series, Replaces Steel Or Aluminum Arm)	Left Lower	RK641504	1
	Four Wheel Drive (4X4), (R-Series, Replaces Steel Or Aluminum Arm)	Right Lower	RK621602	1
<b>Sway Bar Bushing</b>				
2019	Four Wheel Drive (4X4), 24mm Sway Bar Diameter, (Split Design For Easier Installation)	To Frame	K3170 ‡	1
	Four Wheel Drive (4X4), 32mm Sway Bar Diameter, (Improved Design Bushing With Premium Rubber Material And Synthetic Fabric Lining Lasts Longer And Eliminates Noise)	To Frame	K201621 ‡	1
	Four Wheel Drive (4X4), 32mm Sway Bar Diameter, (Standard Design)	To Frame	K7353	1

FRONT SUSPENSION (Cont.)				
Year	Model/Application	Part	P/C Qty	Figure
<b>Sway Bar Bushing</b>				
2019 (Cont.)	Four Wheel Drive (4X4), 36.8mm Sway Bar Diameter	To Frame	K7384	2
<b>Sway Bar Link</b>				
2019	(Powdered Metal Gusher Brg. For Better Lubrication)		K80894 ‡	2
STEERING				
Year	Model/Application	Part	P/C Qty	Figure
<b>Tie Rod End</b>				
2019		Outer	ES801123	2
REAR SUSPENSION				
Year	Model/Application	Part	P/C Qty	Figure
<b>Control Arm</b>				
2019	(R-Series)	Upper	RK642932	2
<b>Sway Bar Link</b>				
2019	(Full Ball Stud Provides 360 Degrees Of Smooth Rotation)		K750396 ‡	2
<b>Track Bar</b>				
2019	(R-Series)		RK661215	1

2500-RAM TRUCK

