

JEEP-Compass (Cont.)

REAR SUSPENSION (Cont.)

Year	Model/Application	Part	P/C Qty	Figure
Wheel Hub & Bearing Assembly				
2016-2007	Four Wheel Drive (4X4) Front Wheel Drive	512333 512332	2 2	

JEEP-Grand Cherokee

FRONT SUSPENSION

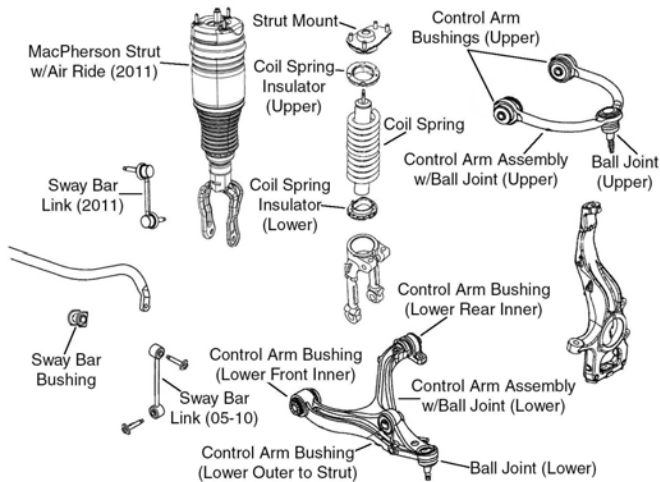

F374

Year	Model/Application	Part	P/C Qty	Figure	
Ball Joint					
2015-2011	(Full Ball Stud Provides 360 Degrees Of Smooth Rotation) +/- 1 Degree Camber/Caster, (Adjustable, Greaseable Socket Reduces Corrosion/Wear)	Upper Upper	K500285 ‡ K100107 ‡	2 2	F374 F374
2010-2005	(Non-Adjustable, Powdered Metal Gusher Brg. For Better Lubrication) (Powdered Metal Gusher Brg. For Better Lubrication, New Pre-Installed Integral Dust Boot Eases Installation, New And Original Designs Can Be Installed) +/- 1 Degree Camber/Caster, (Adjustable)	Upper Lower Upper	K80604 ‡ K80629 ‡ K100071 ‡	2 2 2	F374 F374 F374
Control Arm Bushing					
2015-2011		Upper Left Rear Lower Lower Center Inner Lower Front Inner Right Rear Lower	K201338 K201334 K201333 K201261 K201335	4 1 1 2 1	F374 F374 F374 F374 F374
2010-2006	370(6.1L)	Lower Front Inner	K201261	2	F374
2010-2005	(Contains Front And Rear Bushings) (High Quality Elastomer For Durability And Performance) (High Quality Elastomer For Durability And Performance) (High Quality Elastomer For Durability And Performance)	Upper Lower Rear Lower Front Lower Control Arm At Strut	K200113 ‡ K200182 ‡ K200181 ‡ K200183 ‡	2 2 2 2	F374 F374 F374 F374
Control Arm with Ball Joint					
2015-2011	(R-Series) (R-Series) (R-Series) (R-Series) +/- 1 Degree Camber/Caster, (Adjustable, R-Series) +/- 1 Degree Camber/Caster, (Adjustable, R-Series)	Left Upper Right Upper Left Lower Right Lower Left Upper Right Upper	RK621608 RK621607 RK642831 RK642830 RK100168 RK100169	1 1 1 1 1 1	F374 F374 F374 F374 F374 F374
2010-2006	226(3.7L), (R-Series) 226(3.7L), (R-Series) 345(5.7L), (R-Series) 345(5.7L), (R-Series) 370(6.1L), (R-Series) 370(6.1L), (R-Series)	Left Lower Right Lower Left Lower Right Lower Left Lower Right Lower	RK621375 RK621374 RK621375 RK621374 RK621567 RK621566	1 1 1 1 1 1	F374 F374 F374 F374 F374 F374
2010-2005	(Contains Bushing, Powdered Metal Gusher Brg. For Better Lubrication) (R-Series)	Upper Upper	CK620188 ‡ RK620188	2 2	F374 F374
2009-2007	182(3.0L), (R-Series) 182(3.0L), (R-Series)	Left Lower Right Lower	RK621375 RK621374	1 1	F374 F374
2009-2006	287(4.7L), (R-Series) 287(4.7L), (R-Series)	Left Lower Right Lower	RK621375 RK621374	1 1	F374 F374
Strut and Spring Assembly					
2010-2006	226(3.7L) 345(5.7L)	Left Left	ST8641 ST8641	1 1	F374 F374

FRONT SUSPENSION (Cont.)					
Year	Model/Application	Part	P/C Qty	Figure	
Strut and Spring Assembly					
2009-2007	182(3.0L)	Left	ST8641	1	F374
2009-2006	287(4.7L)	Left	ST8641	1	F374
Strut Mount					
2010-2005	(Bearing Not Included, Contains Isolators)		K160050 ‡	2	F374
Strut Rubber Bumper					
2010-2005			K201424	2	F374
Sway Bar Bushing					
2010-2007	1.29" Sway Bar Diameter, (Reduces Noise)	To Frame	K200159 ‡	1	F374
	1.34" Sway Bar Diameter, (Reduces Noise)	To Frame	K200160 ‡	1	F374
Sway Bar Link					
2015-2014	2987cc(3.0L), Four Wheel Drive (4X4), (Improves Upon OE Design)	Left	K750578 ‡	1	F374
	2987cc(3.0L), Four Wheel Drive (4X4), (Improves Upon OE Design)	Right	K750579 ‡	1	F374
	2987cc(3.0L), Two Wheel Drive (4x2), (Design Allows Ease Of Installation)	Left	K750690 ‡	1	F374
	2987cc(3.0L), Two Wheel Drive (4x2), (Design Allows Ease Of Installation)	Right	K750689 ‡	1	F374
	220(3.6L), Four Wheel Drive (4X4), (Improves Upon OE Design)	Left	K750578 ‡	1	F374
	220(3.6L), Four Wheel Drive (4X4), (Improves Upon OE Design)	Right	K750579 ‡	1	F374
	220(3.6L), Two Wheel Drive (4x2), (Design Allows Ease Of Installation)	Left	K750690 ‡	1	F374
	220(3.6L), Two Wheel Drive (4x2), (Design Allows Ease Of Installation)	Right	K750689 ‡	1	F374
	345(5.7L), Four Wheel Drive (4X4), (Improves Upon OE Design)	Left	K750578 ‡	1	F374
	345(5.7L), Four Wheel Drive (4X4), (Improves Upon OE Design)	Right	K750579 ‡	1	F374
	345(5.7L), Two Wheel Drive (4x2), (Design Allows Ease Of Installation)	Left	K750690 ‡	1	F374
	345(5.7L), Two Wheel Drive (4x2), (Design Allows Ease Of Installation)	Right	K750689 ‡	1	F374
2015-2012	392(6.4L), (Design Allows Ease Of Installation)	Left	K750690 ‡	1	F374
	392(6.4L), (Design Allows Ease Of Installation)	Right	K750689 ‡	1	F374
2013-2012	220(3.6L), (Improves Upon OE Design)	Left	K750578 ‡	1	F374
	220(3.6L), (Improves Upon OE Design)	Right	K750579 ‡	1	F374
	345(5.7L), (Improves Upon OE Design)	Left	K750578 ‡	1	F374
	345(5.7L), (Improves Upon OE Design)	Right	K750579 ‡	1	F374
2011	(Improves Upon OE Design)	Left	K750578 ‡	1	F374
	(Improves Upon OE Design)	Right	K750579 ‡	1	F374
2010-2005	(Straight Link With Eyelets On Both Ends)		K80861	2	F374
Wheel Hub & Bearing Assembly					
2018-2011			513324	2	
2010-2005			513234	2	
STEERING					
<p style="text-align: center;">S166</p>					
<p style="text-align: center;">S167</p>					
Year	Model/Application	Part	P/C Qty	Figure	
Tie Rod End					
2015-2011	(Design Allows Ease Of Installation)	Left Outer	ES800973 ‡	1	S167
	(Design Allows Ease Of Installation)	Right Outer	ES800972 ‡	1	S167
	(Design Allows Ease Of Installation)	Inner	EV800987 ‡	2	S167
2010-2005	(Powdered Metal Gusher Brg. For Better Lubrication)	Left Outer	ES80643 ‡	1	S166

JEEP-Grand Cherokee (Cont.)

STEERING (Cont.)

Year	Model/Application	Part	P/C Qty	Figure
Tie Rod End				
2010-2005 (Cont.)	(Powdered Metal Gusher Brg. For Better Lubrication)	Right Outer	ES80644 ‡	1 S166
	(Powdered Metal Gusher Brg. For Better Lubrication)	Inner	EV80782 ‡	2 S166

REAR SUSPENSION

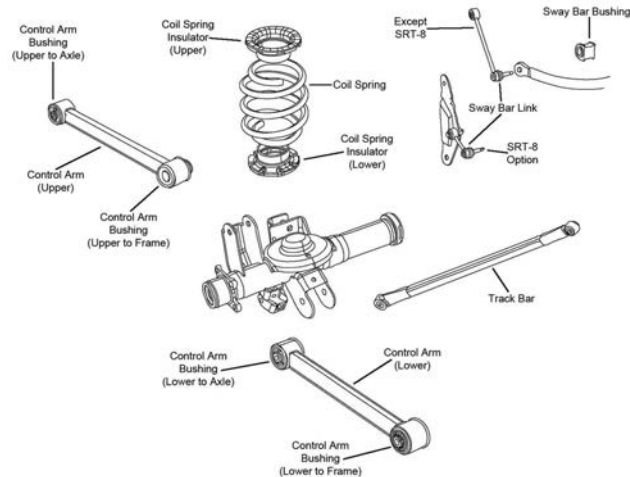

R090

Year	Model/Application	Part	P/C Qty	Figure
Control Arm				
2018-2016	Except Air Suspension, (Lateral Link, R-Series) 2987cc(3.0L), (R-Series) 220(3.6L), (R-Series) 345(5.7L), (R-Series)	Upper Front	RK642900	2
		Lower Rear	RK642940	2
		Lower Rear	RK642940	2
		Lower Rear	RK642940	2
2018-2015		Left Front Lower	RK643099	1
		Right Front Lower	RK643098	1
2015-2011	(Lateral Link, R-Series) (R-Series)	Upper Front	RK642900	2
		Lower Rear	RK642940	2
2010-2006	226(3.7L), (R-Series) 345(5.7L), (R-Series)	Lower	RK641794	2 R090
		Lower	RK641794	2 R090
2010-2005	(R-Series)	Upper	RK641865	2 R090
2009-2007	182(3.0L), (R-Series)	Lower	RK641794	2 R090
2009-2006	287(4.7L), (R-Series)	Lower	RK641794	2 R090
Control Arm Bushing				
2010-2005	(High Quality Elastomer For Durability And Performance) (High Quality Elastomer For Durability And Performance) (High Quality Elastomer For Durability And Performance)	To Axle, Lower Rear	K200178 ‡	2 R090
		To Frame, Lower Front	K200177 ‡	2 R090
		Upper To Frame	K200179 ‡	2 R090
2009-2005	(High Quality Elastomer For Durability And Performance)	Upper To Axle	K200180 ‡	2 R090
Strut Bumper Bellows				
2015-2011	(Replacement Type, Contains Bumper)	K90460	2	
Sway Bar Bushing				
2010-2006	226(3.7L) 345(5.7L)	To Frame	K201557	1 R090
		To Frame	K201557	1 R090
2009-2007	182(3.0L)	To Frame	K201557	1 R090
2009-2006	287(4.7L)	To Frame	K201557	1 R090
Sway Bar Link				
2018	376(6.2L), (Greaseable Socket Reduces Corrosion/Wear)	K750710 ‡	2	
2018-2016	2987cc(3.0L), Four Wheel Drive (4X4), (Improves Upon OE Design) 2987cc(3.0L), Two Wheel Drive (4x2), (Greaseable Socket Reduces Corrosion/Wear) 220(3.6L), Four Wheel Drive (4X4), (Improves Upon OE Design) 220(3.6L), Two Wheel Drive (4x2), (Greaseable Socket Reduces Corrosion/Wear) 345(5.7L), Four Wheel Drive (4X4), (Improves Upon OE Design) 345(5.7L), Two Wheel Drive (4x2), (Greaseable Socket Reduces Corrosion/Wear)	K750573 ‡	2	
		K750710 ‡	2	
		K750573 ‡	2	
		K750710 ‡	2	
		K750573 ‡	2	
		K750710 ‡	2	
2018-2012	392(6.4L), (Greaseable Socket Reduces Corrosion/Wear)	K750710 ‡	2	
2014	2987cc(3.0L), Two Wheel Drive (4x2), (Greaseable Socket Reduces Corrosion/Wear) 220(3.6L), Two Wheel Drive (4x2), (Greaseable Socket Reduces Corrosion/Wear) 345(5.7L), Two Wheel Drive (4x2), (Greaseable Socket Reduces Corrosion/Wear)	K750710 ‡	2	
		K750710 ‡	2	
		K750710 ‡	2	
2010-2006	226(3.7L), (Greaseable Link Kit)	K80468 ‡	2 R090	

REAR SUSPENSION (Cont.)				
Year	Model/Application	Part	P/C Qty	Figure
Sway Bar Link				
2010-2006 (Cont.)	345(5.7L), (Greaseable Link Kit)	K80468 ‡	2	R090
2009-2007	182(3.0L), (Greaseable Link Kit)	K80468 ‡	2	R090
2009-2006	287(4.7L), (Greaseable Link Kit)	K80468 ‡	2	R090
Sway Bar Repair Kit				
2010-2006	370(6.1L), (Powdered Metal Gusher Brg. For Better Lubrication)	K750310 ‡	2	R090
Track Bar				
2010-2005	(R-Series)	RK660154	1	R090
Track Bar Bushing				
2010-2005	(OE 1 Piece Design)	K7252 ‡	1	R090
Wheel Hub & Bearing Assembly				
2010-2005		512302	2	

Liberty–JEEP

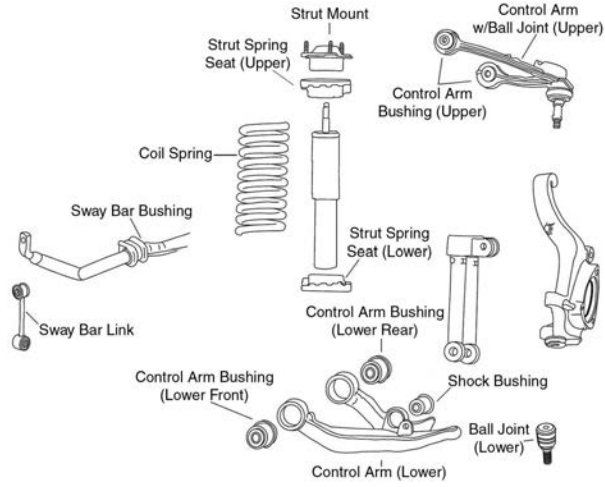
FRONT SUSPENSION				
				
F227				
Year	Model/Application	Part	P/C Qty	Figure
Ball Joint				
2012-2008	(Powdered Metal Gusher Brg. For Better Lubrication, New Pre-Installed Integral Dust Boot Eases Installation, New And Original Designs Can Be Installed)	Lower K80629 ‡	2	F227
2007-2005	(Powdered Metal Gusher Brg. For Better Lubrication)	Lower K80767 ‡	2	F227
Control Arm				
2007-2002	(R-Series)	Left Lower RK641558	1	F227
	(R-Series)	Right Lower RK641559	1	F227
Control Arm Bushing				
2012-2008	(High Quality Elastomer For Durability And Performance)	Lower Control Arm At Strut K200427 ‡	2	F227
2007-2002	(High Quality Elastomer For Durability And Performance)	Strut To Arm Lower K200258 ‡	2	F227
Control Arm Bushing Set				
2012-2002	(Contains Front And Rear Bushings)	Upper K7390	2	F227
	(Contains Front And Rear Bushings)	Lower K7389	2	F227
Control Arm with Ball Joint				
2012-2008	(R-Series)	Left Upper RK621564	1	F227
	(R-Series)	Right Upper RK621565	1	F227
	(R-Series)	Left Lower RK622148	1	F227
	(R-Series)	Right Lower RK622147	1	F227
2007-2002	(Full Ball Stud Provides 360 Degrees Of Smooth Rotation)	Upper CK3198 ‡	2	F227
	(R-Series)	Upper RK3198	2	F227
Strut and Spring Assembly				
2012-2007	(Coated For Corrosion Resistance, Strut, Spring & Top Mount)	Left ST8565L ‡	1	F227
	(Coated For Corrosion Resistance, Strut, Spring & Top Mount)	Right ST8565R ‡	1	F227
Strut Bumper Bellows				
2007-2002	(Contains Bellow)	K201419	2	F227